

siegling proposition

timing belts

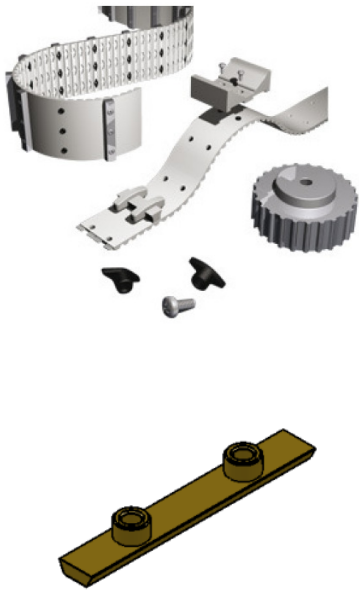

Mechanical cam fastener

Properties/advantages

- Use of product-specific cams, by fixing these to brass auf teeth, placed where the original teeth have been ground away.

Applications

- For standard timing belts T10/AT10/T20/AT20/XH
- Standard widths: 25 mm/32 mm/50 mm (other widths on request)
- Product-specific pusher dogs and cams can be fitted without extra tools
- Timing belts can be easily converted

Basic technical data

Type T10, AT10, T20 and AT20:
A: 25 mm widths B: 12,5 mm
A: 32 mm widths B: 16 mm
A: 50 mm widths B: 25 mm

Type H:
A: 25,4 mm widths B: 12,5 mm
A: 38,1 mm widths B: 25 mm
A: 50,8 mm widths B: 25 mm

For details see next page

siegling proposition

timing belts

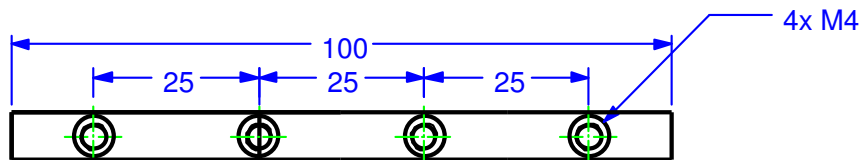
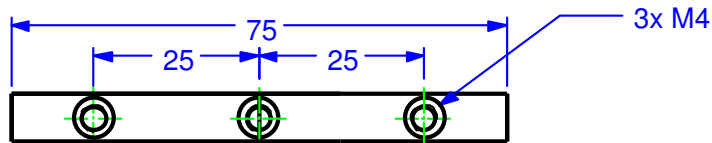
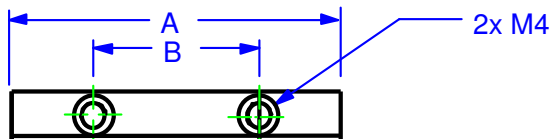
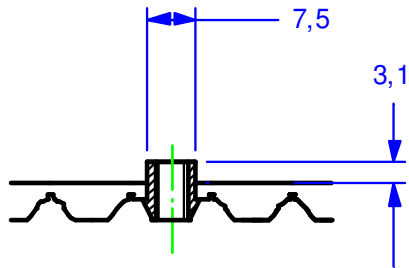

184.2

FMS · Reproduction of text or parts thereof only
with our approval.
Modifications reserved.

Forbo Siegling Nederland BV
Van Rensselaerweg 1
NL - 6956 AV Spankeren
Tel +31 313 491114, Fax +31 313 4922314
Email: oscar.rondeel@forbo.com