

SERIES 19 | BELT TYPES

siegling prolink
modular belts

Straight running belt | Pitch 63.5 mm (2.5 in)

S19-0 SRS | 0% Opening | Slip Resistant Surface

Extreme heavy-duty belt | Steel Reinforcement Links (REL) possible | Wear inserts (INS) possible

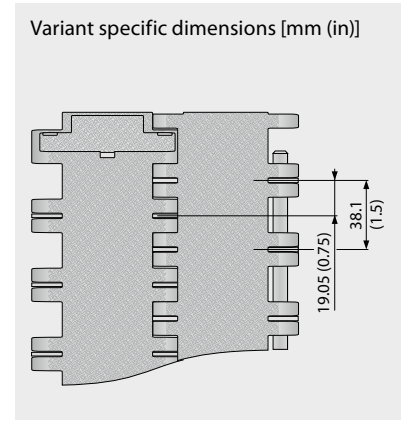
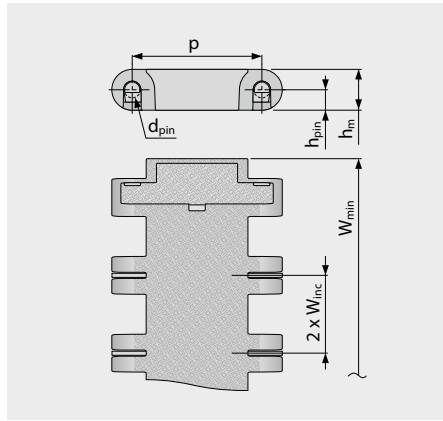
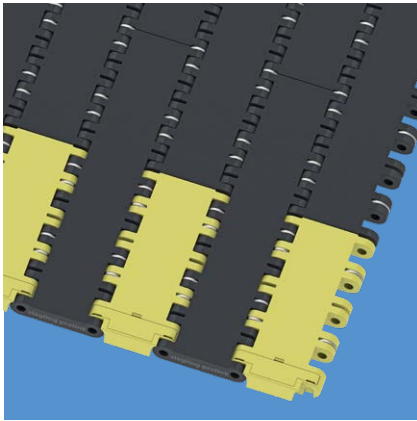

Belt dimensions

	p	d _{pin}	h _m	h _{pin}	h _s	W _{min}	W _{inc}	W _{tol}	Minimum flex radii ¹⁾				
	Pitch	Pin Ø	Thickness	Pin position	Height	Width min.	Width Increment	Width tolerance [%]	r1 C _c x W _B	r2	r3	r4	r5
mm	63.5	8.0	20.0	10.0	0.0	304.8	19.1	±0.2	–	63.5	127.0	190.5	63.5
inch	2.50	0.31	0.79	0.39	0.0	12.0	0.75	±0.2	–	2.50	5.00	7.50	2.50

Available standard materials³⁾

Belt		Pin Material	REL		Nominal belt pull, straight		Weight (incl. INS)		Temperature		Width deviation [%]	Certificates ²⁾ Flame retardant
Material	Color		Spacing [in]	[%]	[N/mm]	[lb/ft]	[kg/m ²]	[lb/ft ²]	[°C]	[°F]		
POM	AT	SS	1.5	100	180	12334	29.8	6.10	-45/90	-49/194	-0.1	–
POM	AT	SS	3.0	50	140	9593	26.7	5.47	-45/90	-49/194	-0.1	–
POM	AT	SS	4.5	33	130	8908	24.7	5.06	-45/90	-49/194	-0.1	–
POM	AT	SS	6.0	25	110	7535	23.7	4.85	-45/90	-49/194	-0.1	–
POM	AT	SS	–	0	90	6167	23.6	4.83	-45/90	-49/194	-0.1	–
PA-FR*	BK	SS	1.5	100	170	11649	27.2	5.57	-40/120	-40/248	0.28	●
PA-FR*	BK	SS	3.0	50	130	8908	24.1	4.94	-40/120	-40/248	0.28	●
PA-FR*	BK	SS	4.5	33	120	8226	22.0	4.51	-40/120	-40/248	0.28	●
PA-FR*	BK	SS	6.0	25	100	6852	21.1	4.32	-40/120	-40/248	0.28	●
PA-FR*	BK	SS	–	0	80	5482	21.0	4.30	-40/120	-40/248	0.28	●

* Values valid for dry applications (RH <50%). Belts in PA-FR material will absorb water in wet environments, causing them to expand and reduce the nominal belt pull capacity.

■ AT (Anthracite), ■ BK (Black)

All measurements and tolerances apply at 21 °C; for temperature deviations please see ProLink manual chapter 4.4 "Temperature influence".

All imperial dimensions (inches) are rounded off.

¹⁾ Flex radii: r1 = side flex, r2 = front flex on roller, r3 = back flex on load bearing roller, r4 = back flex on Hold Down shoe, r5 = back flex on roller

²⁾ Complies with DIN EN 13501-1 Bfl-s1 (and DIN 4102 B1)

● = available | – = not available | empty cells = not tested

³⁾ More materials and colors on request



MOVEMENT SYSTEMS

SERIES 19 | BELT TYPES

siegling prolink
modular belts

Straight running belt | Pitch 63.5 mm (2.5 in)

S19-0 SRS HC | 0% Opening | Slip Resistant Surface | Highly Conductive

Extreme heavy-duty belt | Steel Reinforcement Links (REL) possible | Wear inserts (INS) possible

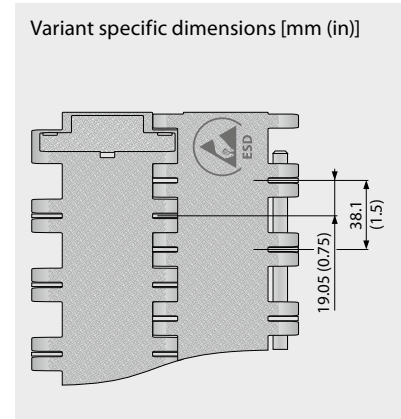
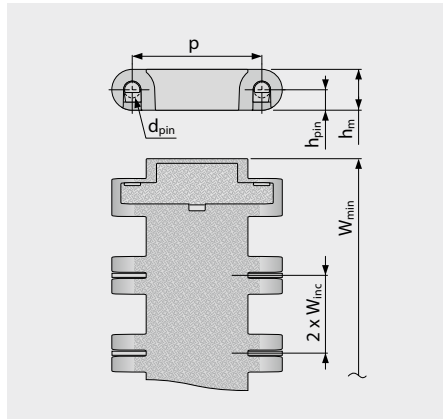
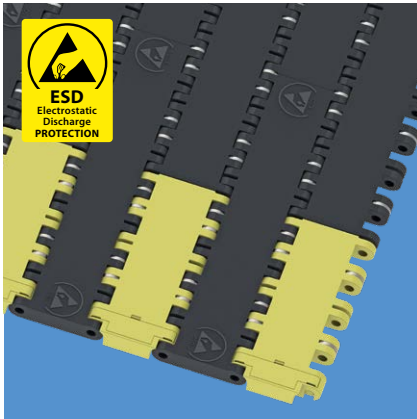

Belt dimensions

	p	d _{pin}	h _m	h _{pin}	h _s	W _{min}	W _{inc}	W _{tol}	Minimum flex radii ¹⁾				
	Pitch	Pin Ø	Thickness	Pin position	Height	Width min.	Width Increment	Width tolerance [%]	r1 C _c x W _B	r2	r3	r4	r5
mm	63.5	8.0	20.0	10.0	0.0	304.8	19.1	±0.2	–	63.5	127.0	190.5	63.5
inch	2.50	0.31	0.79	0.39	0.0	12.0	0.75	±0.2	–	2.50	5.00	7.50	2.50

Available standard materials³⁾

Belt		Pin Material	REL		Nominal belt pull, straight		Weight (incl. INS)		Temperature		Width deviation [%]	Certificates ²⁾ Flame retardant
Material	Color		Spacing [in]	[%]	[N/mm]	[lb/ft]	[kg/m ²]	[lb/ft ²]	[°C]	[°F]		
POM-HC	AT	SS	1.5	100	160	10963	29.8	6.10	-45/90	-49/194	-0.1	–
POM-HC	AT	SS	3.0	50	135	9250	26.7	5.47	-45/90	-49/194	-0.1	–
POM-HC	AT	SS	4.5	33	120	8223	24.7	5.06	-45/90	-49/194	-0.1	–
POM-HC	AT	SS	6.0	25	100	6852	23.7	4.85	-45/90	-49/194	-0.1	–
POM-HC	AT	SS	–	0	80	5482	23.6	4.83	-45/90	-49/194	-0.1	–
PA-FRHC*	BK	SS	1.5	100	155	10621	27.2	5.57	-40/120	-40/248	0.28	●
PA-FRHC*	BK	SS	3.0	50	115	7880	24.1	4.94	-40/120	-40/248	0.28	●
PA-FRHC*	BK	SS	4.5	33	110	7537	22.0	4.51	-40/120	-40/248	0.28	●
PA-FRHC*	BK	SS	6.0	25	90	6167	21.1	4.32	-40/120	-40/248	0.28	●
PA-FRHC*	BK	SS	–	0	70	4797	21.0	4.30	-40/120	-40/248	0.28	●

* Values valid for dry applications (RH <50%). Belts in PA-FRHC material will absorb water in wet environments, causing them to expand and reduce the nominal belt pull capacity.

■ AT (Anthracite), ■ BK (Black)

All measurements and tolerances apply at 21 °C; for temperature deviations please see Prolink manual chapter 4.4 "Temperature influence".

All imperial dimensions (inches) are rounded off.

¹⁾ Flex radii: r1 = side flex, r2 = front flex on roller, r3 = back flex on load bearing roller, r4 = back flex on Hold Down shoe, r5 = back flex on roller

²⁾ Complies with DIN EN 13501-1 Bfl-s1 (and DIN 4102 B1)

● = available | – = not available | empty cells = not tested

³⁾ More materials and colors on request



MOVEMENT SYSTEMS

SERIES 19 | SPROCKETS

siegling prolink
modular belts

Straight running belt | Pitch 63.5 mm (2.5 in)

S19 SPR | Sprockets

Deep tooth engagement for heavy loads | Machined sprocket

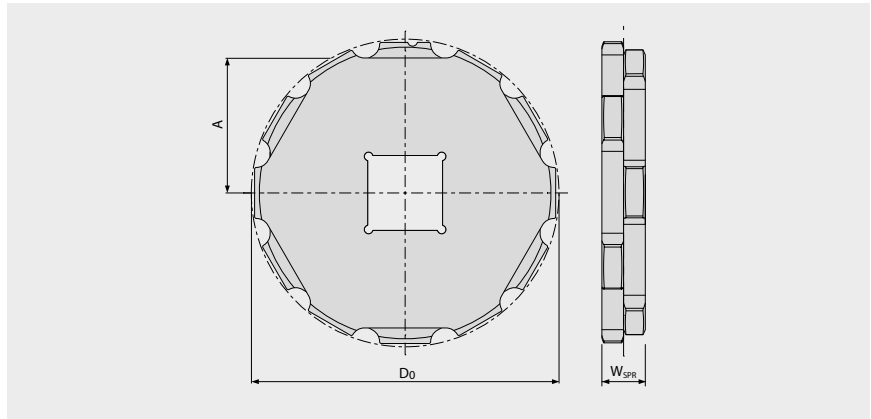
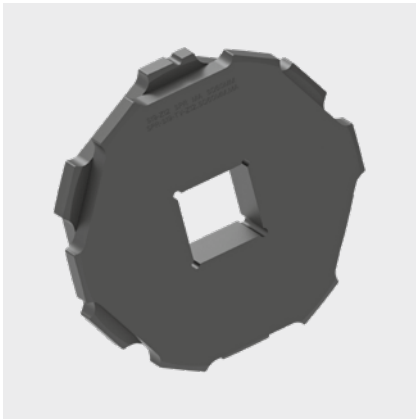

Main dimensions

Sprocket size (Number of teeth)		Z8	Z10	Z12	Z14	Z16
W _{spr}	mm	35	35	35	35	35
	inch	1.38	1.38	1.38	1.38	1.38
D ₀	mm	168.2	207.8	247.6	287.6	327.4
	inch	6.62	8.18	9.75	11.32	12.89
A _{max}	mm	72.4	92.5	112.7	132.8	152.9
	inch	2.85	3.64	4.44	5.23	6.02
A _{min}	mm	66.9	88.0	108.9	129.5	150.0
	inch	2.63	3.46	4.29	5.10	5.90

Shaft bores

	mm	60	60 – 90	60 – 120	60 – 140	60 – 160
	inch	2.0	2.5 – 3.5	2.5 – 4.5	2.5 – 5.5	2.5 – 7.5

The machined sprockets are available in different sizes and bore diameter.
The chart shows a selection of available sizes – other sizes on request.

Material: PA, Color: BK

■ BK (Black)

All measurements and tolerances apply at 21 °C.
All imperial dimensions (inches) are rounded off.
For detailed sprocket and shaft dimensions see appendix 6.3



MOVEMENT SYSTEMS

SERIES 19 | SPLIT SPROCKETS

siegling prolink
modular belts

Straight running belt | Pitch 63.5 mm (2.5 in)

S19 SPR-SP | Split Sprockets

Easy assembly without dismounting shaft | Deep tooth engagement for heavy loads | Machined sprocket

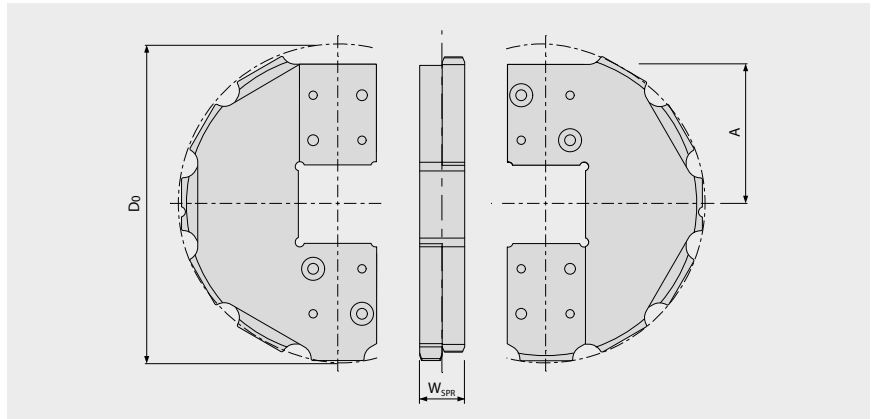
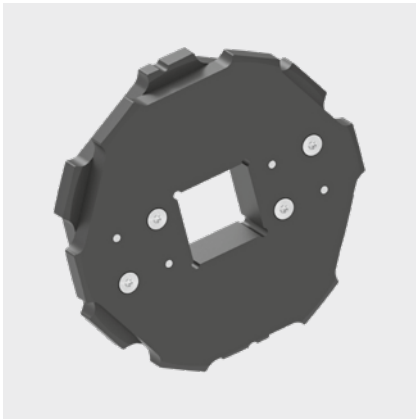

Main dimensions

Sprocket size (Number of teeth)		Z8	Z10	Z12	Z14	Z16
W _{spr}	mm	35	35	35	35	35
	inch	1.38	1.38	1.38	1.38	1.38
D ₀	mm	168.2	207.8	247.6	287.6	327.4
	inch	6.62	8.18	9.75	11.32	12.89
A _{max}	mm	72.4	92.5	112.7	132.8	152.9
	inch	2.85	3.64	4.44	5.23	6.02
A _{min}	mm	66.9	88.0	108.9	129.5	150.0
	inch	2.63	3.46	4.29	5.10	5.90

Shaft bores

	mm	60	60 – 90	60 – 120	60 – 140	60 – 160
	inch	2.0	2.5 – 3.5	2.5 – 4.5	2.5 – 5.5	2.5 – 7.5

The machined sprockets are available in different sizes and bore diameter.
The chart shows a selection of available sizes – other sizes on request.

Material: PA, Color: BK

■ BK (Black)

All measurements and tolerances apply at 21 °C.
All imperial dimensions (inches) are rounded off.
For detailed sprocket and shaft dimensions see appendix 6.3



MOVEMENT SYSTEMS

SERIES 19 | WHEELSTOPPER

siegling prolink
modular belts

Straight running belt | Pitch 63.5 mm (2.5 in)

S19-0 | WSC/Wheelstopper

Small and stiff profiles (interrupted for finger plates)

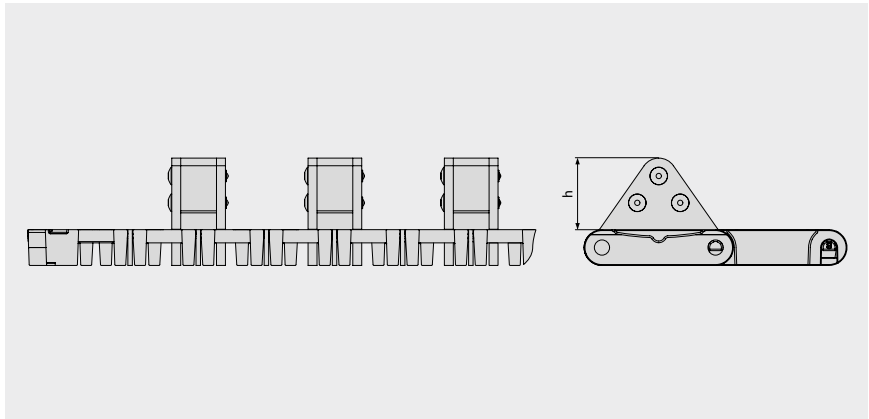

Basic data

Material	Color	Height (h)
		40 mm 1.57 inch
SS/POM	BK/YL	Height and angle customizable

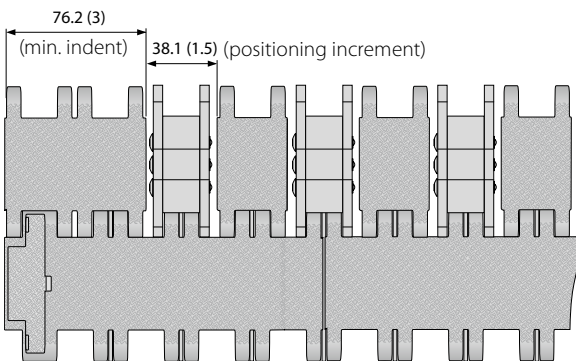

Configuration S19-0 SRS WSC

■ BK (Black), ■ YL (Yellow)

All measurements and tolerances apply at 21 °C; for temperature deviations please see Prolink manual chapter 4.4 "Temperature influence".

All imperial dimensions (inches) are rounded off.

Note: Use of accessory in a belt may impact on the minimum design radii. Please see chapter 6.3 for further information.



MOVEMENT SYSTEMS