

Forbo Floor Care - Flotex

Floor Care Chemicals & Equipment

The unique construction of Forbo Flotex® sheet, tile and plank flooring is what allows it to release soiling like no other textile flooring can. Unlike the looped and twisted fibres of conventional carpet tile, the smooth straight fibres of Flotex do not trap particles of soil, allowing them to be removed without difficulty during cleaning. Typically, Flotex only requires water for cleaning, but in certain circumstances, a hydrogen peroxide cleaner or a degreaser may be used as a pre-spray. Cleaner should only be applied as a pre-spray, not applied with a machine. All cleaners should be diluted per the label directions and tested on a scrap piece of material to ensure compatibility with the flooring for colourfastness to avoid damage.

Note: Do not use bleach near Flotex, instead use chlorine-free hospital grade disinfectant. Damage caused to Forbo floors from the improper use of floor care chemicals and equipment is NOT covered under Forbo's warranty.

Initial / Routine Cleaning

Newly installed floors must be protected from construction soil, traffic and damage. Initial cleaning procedures should be performed on all new installations exposed to normal construction soil and traffic. It is recommended to wait a minimum of three days before conducting any wet cleaning procedures in order to allow the adhesive to dry and cure properly. This timeframe can vary, depending on the substrate, site conditions and/or the adhesive used. Routine cleaning is typically performed a minimum of once a day, depending on the application, type of traffic and hours of operation. Contact Forbo head office for additional information.



1. Remove all surface debris by vacuuming using a dual motor upright vacuum with a rotating brush. Make several passes with the vacuum cleaner to ensure that all loose dirt is removed.

NOTE: Forbo Flotex® requires basic routine care to keep it clean and prevent the accumulation of dirt and soil. Proper cleaning, such as daily vacuuming and routine self-contained water extraction can reduce contamination to virtually non-existent levels. Identify sources of soiling and react to spills immediately before they dry.

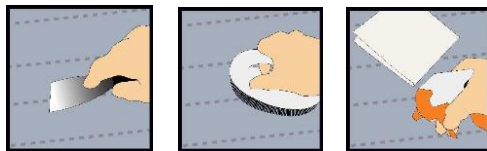

2. Spot clean as necessary using the "Scrape, Scrub & Rinse" cleaning method..

Scrape, Scrub & Rinse Cleaning Method

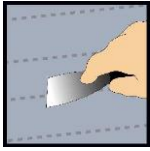

1. **SCRAPE** up spills and Spots using a spatula or blunt edge scraper and wipe excess soil onto a cloth.

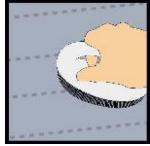

2. Apply a liberal amount of clean water to the spot.
3. **SCRUB** the area using a dull putty knife or 5-in-1 tool. Don't be afraid to use aggressive scrubbing to remove set-in spills or Spots. A stiff nylon brush can be used to remove scuff marks or other set in Spots.

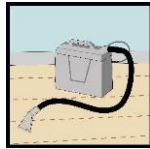

4. Recover the water and the remains of the spill or stain into a paper towel or cloth. Keep scraping until the spill or stain is completely removed. A spotter machine may be used to perform rinsing and recovery of the spill or stain.



5. If the spill or stain is not completely removed, refer to Forbo's "Forbo Flotex® Stain Chart on page 5" for a list of Spots and the recommended cleaning agent to remove them. If using a cleaning agent, do NOT leave any residue on Forbo Flotex®. Any chemicals applied to the flooring must be removed. The most common problem when caring for Forbo Flotex® is the over use of cleaning chemicals. The buildup of chemicals and cleaners will de-luster the Forbo Flotex® fibres and leave a dull appearance. Chemical buildup also attracts dirt faster and speeds soiling. Dilute chemicals in strict accordance with the manufacture's recommendations. Repeat Step 4.

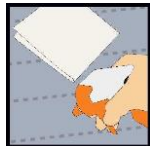

6. **RINSE** the area thoroughly with clean water to ensure that any cleaning solution is completely removed.

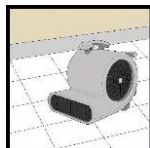

7. Allow the floor to dry thoroughly before allowing traffic. Provide good ventilation or use a floor mounted air blower if necessary.

Interim Cleaning

Cleaning performed as needed, depending on the application, type of traffic and hours of operation. The following processes should be followed when the routine cleaning is not removing the soil from the floor.

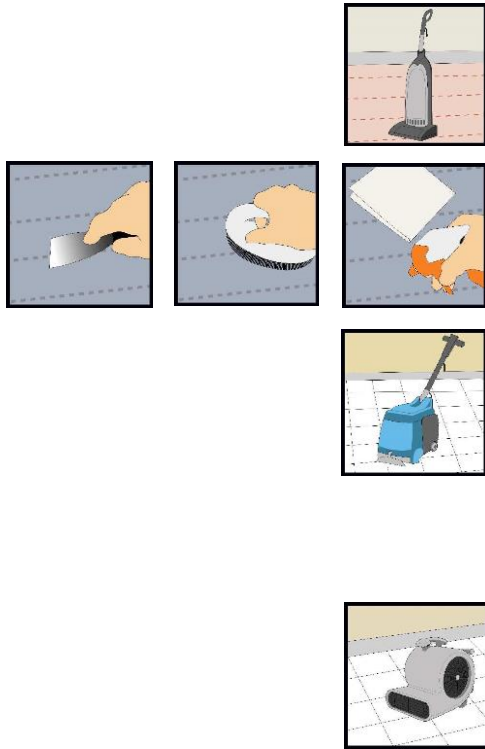

1. Remove all surface debris by vacuuming using a dual motor upright vacuum with a rotating brush.
2. Spot clean as necessary using the "Scrape, Scrub & Rinse" cleaning method.
3. Use a 3 in 1 extractor or cylindrical carpet scrubber machine, preferably with counter-rotating brushes, using clean water only. Set the brushes to ensure maximum agitation and contact with the fibres.
4. Follow each wet pass with a minimum of two dry passes.
5. Best practice is to allow the floor to dry for a minimum of 3 hours. Use a floor mounted air blower if necessary. If traffic is allowed on the floor before it has completely dried, the fibres are more susceptible to attract soil, requiring additional cleaning to achieve the desired result.

Restoration Cleaning

Restoration cleaning is important to maintain Forbo Flotex®. Periodically following the steps below will aid in the overall appearance of the floor. A good indication that restoration cleaning is required is when interim cleaning is not removing the soil from the floor.

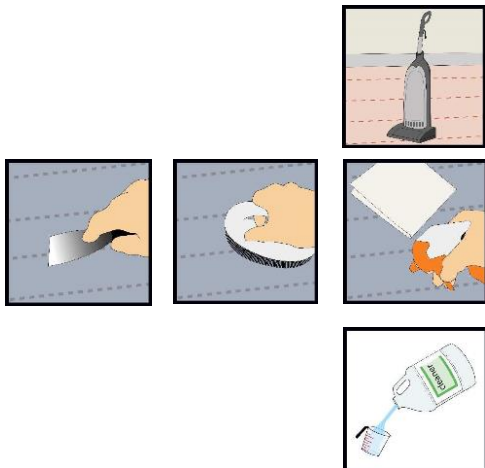

1. Remove all surface debris by vacuuming using a dual motor upright vacuum with a rotating brush.
2. Spot clean as necessary using the "Scrape, Scrub & Rinse" cleaning method.
3. Mix a cleaning solution by diluting a neutral pH cleaner in strict accordance with the manufacturer's recommendations. The pH of the cleaning solution must be between 6.0 – 8.0 pH and a non-foaming solution.

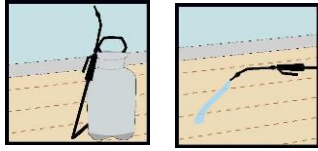

4. Apply the cleaning solution to the floor with a pump sprayer. Allow the solution to dwell on the floor for 5 – 10 minutes. Additional dwell time may be necessary for heavily soiled floors.

IMPORTANT!! THE ENTIRE FLOOR MUST BE COMPLETELY WET BEFORE MOVING TO THE NEXT STEP.

If the floor is not wet enough the friction between the nylon fibres of Forbo Flotex® and the brush can cause the machine to become uncontrollable.



5. Scrub the floor with a diluted neutral pH cleaner according to manufacturer's recommendation using either a rotary, 3 in 1 or cylindrical carpet scrubber.

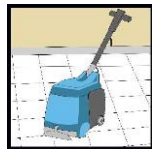

6. Remove water by using extraction equipment and repeat if necessary with fresh water.

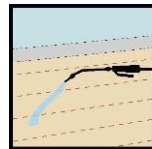

7. Best practice is to allow the floor to dry for a minimum of 3 hours. If traffic is allowed on the floor before it has completely dried, the fibres are more susceptible to attract soil, requiring additional cleaning to achieve the desired result. Use a floor mounted air blower if necessary.

NOTE: Weather, traffic and geographical location will influence the required frequency of this procedure. For example, in areas where there are large amounts of soil and sand it will likely be necessary to perform this procedure more frequently. In dry climates, or where there is less dirt traffic, it may not be necessary to perform this procedure as frequently.

Contact us:

Web: www.forbo-flooring.com.au

Email: info.au@forbo.com

Telephone: 1800 224 471

Fax: 1800 662 566

For ALL stains, the Scrape, Scrub & Rinse procedures should be followed.
 ALWAYS perform a test in an inconspicuous area for colour fastness. ALWAYS rinse the area with clean water thoroughly to ensure that any cleaners are removed from the material.

Water based stains are cleaned with water.

Solvent based stains are cleaned with a General Purpose Spotter/ Cleaner.

Results may vary based on brand or colour of staining agent

Staining Agent	Recommended Cleaning Agent
Adhesive	General Purpose Spotter / Cleaner – non foaming
Beverages (including fruit juice, beer, tea & coffee)	Water
Oil, Butter, mayonnaise & margarine	General Purpose Spotter / Cleaner – non foaming
Canned Fruit	Water
Chalk	Water
Chocolate	General Purpose Spotter / Cleaner – non foaming
Clay	Water
Cough Syrup	Water
Glue	General Purpose Spotter / Cleaner – non foaming
Grease	General Purpose Spotter / Cleaner -non foaming
Gum	General Purpose Spotter / Cleaner -non foaming
Hand Lotion	General Purpose Spotter / Cleaner -non foaming
Honey	Water
Ice Cream	General Purpose Spotter / Cleaner -non foaming
Ink	General Purpose Spotter / Cleaner -non foaming
Jelly	Water
Tomato sauce	Water
Lipstick	General Purpose Spotter / Cleaner -non foaming
Liquor	Water
Milk	Water
Paint	General Purpose Spotter / Cleaner – non foaming
Peanut Butter	Water
Permanent Marker	Rubbing Alcohol
Rust	Hydrogen Peroxide
Soft Drinks	Water
Soy Sauce	General Purpose Spotter / Cleaner – non foaming
Tar	General Purpose Spotter / Cleaner -non foaming
Tomato Paste	General Purpose Spotter / Cleaner -non foaming
Toner	General Purpose Spotter / Cleaner -non foaming
Toothpaste	Water
Water Colour Paint	Water
Wine	Hydrogen Peroxide