

Installation Guide: Sheet flooring with Flat Skirtings

Product Detailing

Flat Skirtings and Buffer Strips protect the base of walls and doors in a wide range of internal applications. They are easy and flexible to install and are an alternative to timber skirting. Cleaned regularly, they need no maintenance or painting. They are available in a number of different sizes and colours.

Flat Skirtings: Apply the adhesive to the wall and back of the Flat Skirting. Flat Skirtings can be applied before or after the floor covering is laid. Suitable for use as buffer strips, wall protection, plinth and stage bases, stair stringers etc.

Quantum Flooring Accessories

Flat Skirting EB3

Forbo Sheet

Sphera 2mm

Eternal 2mm

Surestep/Safestep 2mm

Modul'up 2mm and 3.45mm

Sarlon 2.6mm and 3.4mm

Marmoleum 2mm, 2.5mm and 3.2mm

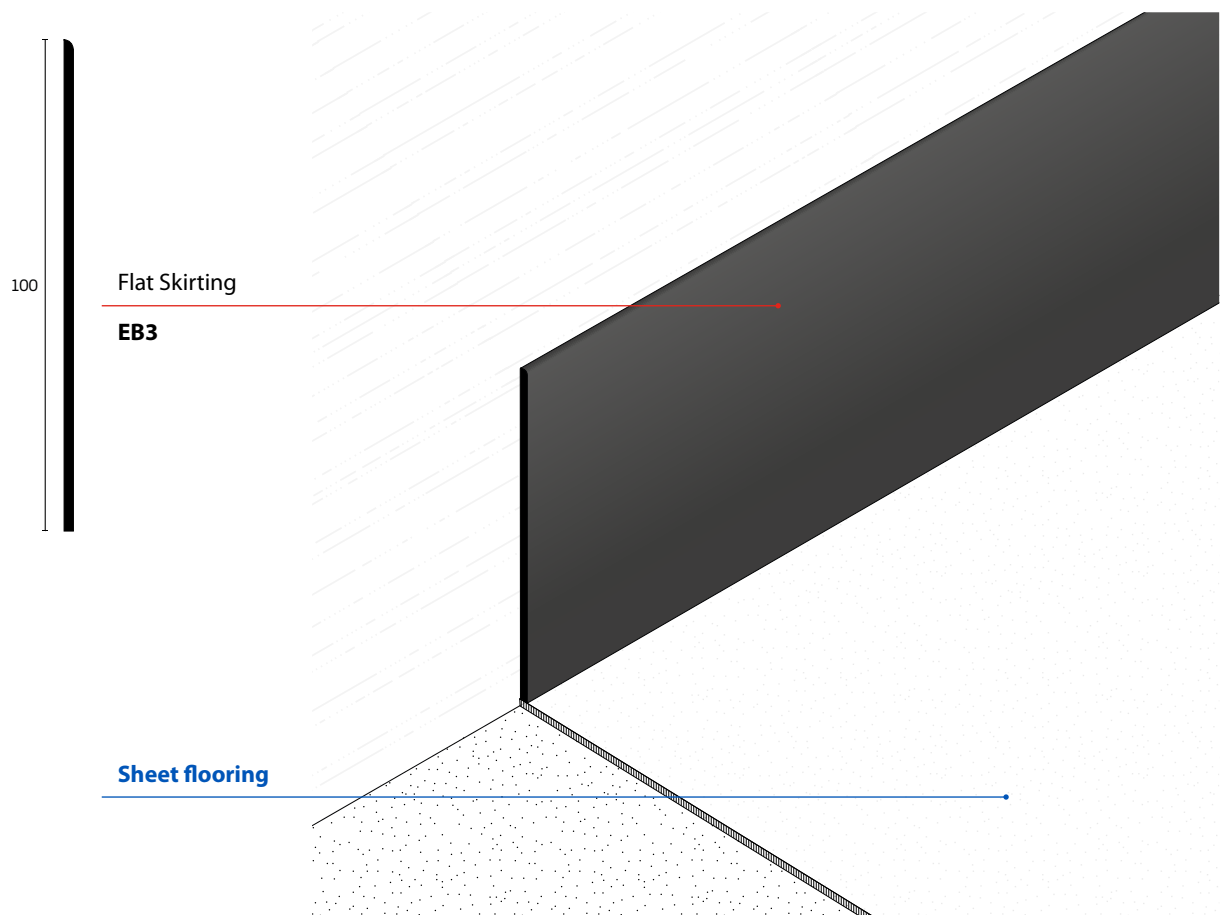

Specification statement

80A FLAT SKIRTING / BUFFER STRIP:

Polyvinyl chloride (PVC) flat skirtings and buffer strips to protect the base of walls and doors in a wide range of internal applications.

Features and benefits:

- Flexible and easy to install alternative to timber skirting.
- Hard-wearing; when applied to doors, will protect bases from shoe scuff marks.
- No maintenance or painting required if cleaned regularly.
- Range of sizes and colours.
- Manufactured in Britain.
- Interior use (QFA20 buffer strip suitable for exterior use).
- Suitable for use with textile or resilient floor coverings.

Manufacturer:

Quantum Flooring Solutions,
a trading name of Quantum Profile Systems Ltd.

Web: www.quantumprofilesystems.com

Tel: +44 (0)161 627 4222

Product reference:

Flat Skirting and Buffer Strip.

Type:

- EB1 - Flat skirting; interior use; height: 50 mm.
- EB2 - Flat skirting; interior use; height: 75 mm.
- EB3 - Flat skirting; interior use; height: 100 mm.
- EB4 - Flat skirting; interior use; height: 150 mm.
- EB12 - Flat skirting; interior use; height: 300 mm.
- EFA75 - 90° corner buffer strip; interior use; 75 x 75 mm.
- QFA20 - 90° corner buffer strip; exterior & interior use; 20 x 20 mm.

Light reflectance value (LRV)/ Colour:

6 Black, 7 Dark Brown, 11 Graphite, 11 Regency, 15 Charcoal, 25 Boulder, 29 Cloud Grey, 31 Caramel, 45 Platinum Grey, 51 Ivory, 81 White

Product Code	Colour Options	Length
EB1 / EB3 / EB4	Black ● Dark Brown ● Regency ● Graphite ● Charcoal ● Boulder ● Cloud Grey ● Caramel ● Platinum Grey ●	23 m
EB12	Ivory ● White ○	16 m
EFA75	Black ●	2 m
QFA20		25 m